

This map is neither a legally recorded map nor a survey and is not intended to be used as such. This map contains a compilation of records, information, and data to be used for reference purposes only. Oconto County is not responsible for any inaccuracies herein contained. Please contact the Oconto County Planning & Zoning Office at 920.834.6827 with any questions.

Source: WDNR; FEMA; NRCS; Oconto County Planning, 2020

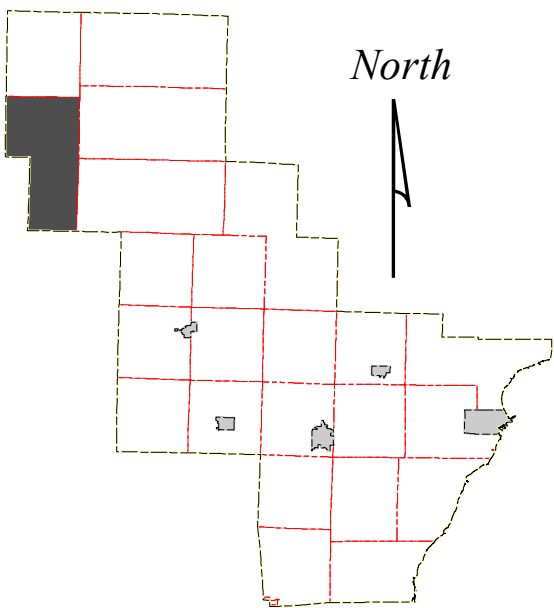

Map 2.4
Plan Determinants
Town of Doty
Oconto County, Wisconsin

- 75' Surface Water Setback
- 100 Year Floodplains
- Steep Slope 12% or Greater
- WDNR Wetlands

Base Map Features

- Federal Highway
- State Highway
- County Highway
- Town Road
- Recreation Trail
- Railroad
- Surface Water
- County Boundary
- City/Village Boundary
- Township Boundary
- Public Land

